

<b>Connection kit</b>	With this interlocking kit, two compressed air instruments can be connected to one another without need for double nipples. This makes possible very compact layouts.
C35 :	<ul style="list-style-type: none"> <li>Mounting using rotary clip and two o-rings. These allow regulators to be connected to other regulators or filters.</li> </ul>
C40 :	<ul style="list-style-type: none"> <li>Instruments are connected to each other using screws, nuts and o-ring;</li> <li>alternatively, a segmented connecting block can be used for instrument connection.</li> </ul>
C50 :	<ul style="list-style-type: none"> <li>Instrument connection by means of a two-part connecting block.</li> </ul>
<b>Branch plate</b>	
C40 :	<ul style="list-style-type: none"> <li>Branch plate with compressed air connection port G<math>\frac{1}{8}</math> or G<math>\frac{1}{4}</math> or both outlet plates.</li> <li>Supply plate for two pressure regulators through port G<math>\frac{1}{4}</math>.</li> </ul>
C50 :	<ul style="list-style-type: none"> <li>Branch plate with compressed air connection G<math>\frac{1}{4}</math>.</li> </ul> <p>Port installation of the branch plate is only possible using connecting blocks.</p>

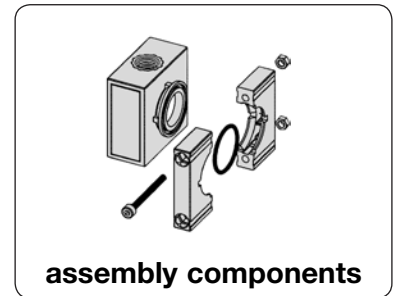

Description	Connection of instruments	for series	Order number
-------------	---------------------------	------------	--------------

Connection kit	for connecting separate instruments	C...	
rotary clips with two o-rings screws, nuts and o-ring	R+F or R+R or F+F	35	<b>C350100018</b>
	F+R+L or P+B+L	42	<b>C400500001</b>
	B+L	42	<b>C400600001</b>
	F+L or F+F	42	<b>C400700001</b>
connection kit	for any two instruments	42	<b>C420600001</b>
		50 / 52	<b>C500600001</b>
		75	<b>C750600001</b>
		80	<b>C800600004</b>
		95	<b>C950600001</b>



Branch plate	with compressed air connection port	C...	
outlet G $\frac{1}{8}$		42	<b>C400500102</b>
outlet G $\frac{1}{4}$		42	<b>C400500108</b>
outlet G $\frac{1}{8}$ and G $\frac{1}{4}$		42	<b>C400500103</b>
outlet G $\frac{1}{8}$ and G $\frac{1}{4}$	with connection kit	42	<b>C420500003</b>
supply G $\frac{1}{4}$ for two regulators		42	<b>C400500111</b>
outlet G $\frac{1}{4}$		50 / 52	<b>C500500003</b>
outlet G $\frac{1}{4}$		75	<b>C750600002</b>
outlet G $\frac{1}{4}$		80	<b>C800600005</b>

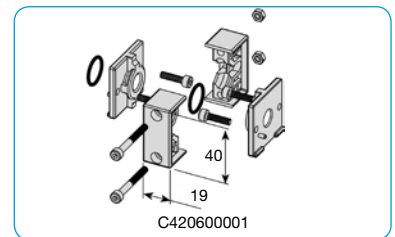

Mounting material			C...
mounting bracket		for G $\frac{1}{4}$	<b>BW30-01</b>
mounting bracket		for G $\frac{3}{8}$ to G $\frac{1}{2}$	<b>BW42-01</b>
wall mounting		for G $\frac{1}{4}$	<b>C420500001</b>
wall mounting		for G1	<b>C950100018</b>
bracket holder	required in absence of C9506	for G1	<b>C950100015</b>

